

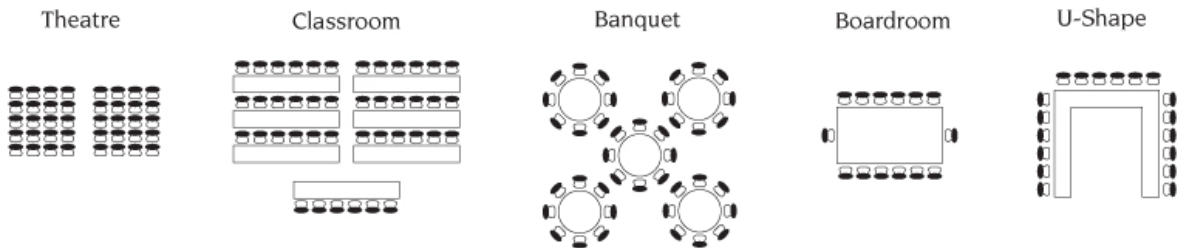

## ROOM CAPACITIES



FUNCTION ROOM	THEATRE	CLASSROOM	BANQUET	BOARDROOM	U-SHAPE
Blythswood Complex	750	450	500	-	-
Blythswood Suite	400	200	200	-	-
Conval Suite	150	100	120	-	-
Blythswood & Conval Suites	550	300	350	-	-
Argyle Suite	200	100	100	-	80
Conval & Argyle Suites	350	150	240	-	-
Birch Suite	150	80	100	-	-
Cedar Suite Full	220	90	100	-	60
Cedar Suite 1	80	40	40	25	20
Cedar Suite 2	60	30	30	20	15
Cedar 1 & 2 Suites	140	50	60	40	30
Cedar Suite 3	40	20	40	25	15
Cedar 2 & 3 Suites	120	40	60	40	30
Elm Suite	150	80	90	50	40
Boardroom	-	-	-	10	-

If the layouts above don't quite meet your requirements please discuss further with your Event Planner

# FLOORPLAN

## THE BLYTHSWOOD, CONVAL AND ARGYLE SUITES

Located on the ground floor with both direct access for your guests from the foyer and level access at the rear for equipment, our suites are perfectly designed to cater for almost any function. The superb Blythswood Suite offers the ideal venue for the larger function with its own bar and dedicated kitchen - ensuring efficiency of service and function.

There is also the added bonus of removable sound proof dividers opening the Blythswood through to the Conval and Argyle Suites making this one of the largest conference venues in the area.

The Conval and Argyle Suites offer the same convenience and flexibility as the Blythswood with their direct access, kitchen and bar facilities.

Together these suites are ideal for conferences, dinner dances, product launches, exhibitions, events and company functions of any size.

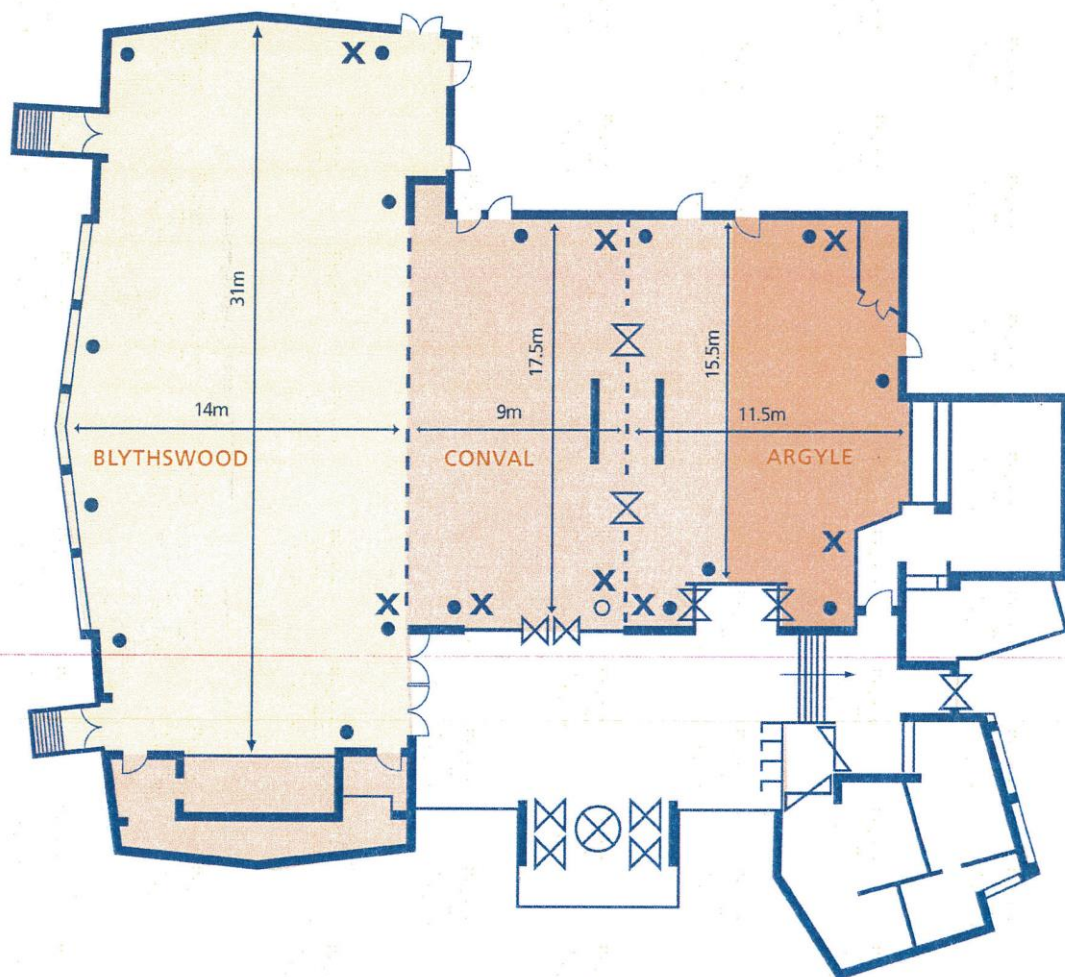

- |                    |                           |
|--------------------|---------------------------|
| <b>KEY</b>         | <b>ACCESS 2.3m x 2.5m</b> |
| ● Power Point      | <b>HEIGHT 3.4m</b>        |
| ○ TV Socket        |                           |
| ⊂ Dimmer Switch    |                           |
| ✕ Telephone Socket |                           |

### NORMANDY HOTEL – GLASGOW AIRPORT

Inchinnan Road, Renfrew, near Glasgow Airport, PA4 9EJ

tel: 0870 246 1780 fax: 0870 246 1781 email: normandysales@cosmopolitan-hotels.com



# FLOORPLAN

## THE CEDAR AND ELM SUITES AND THE BOARDROOM

Located on the ground floor of the hotel the Cedar and Elm Suites offer total flexibility for a full range of meetings, seminars and private functions with the added bonus that the three elements of the Cedar Suite can quickly be opened up into one large room. Being of uniformed shape these suites are ideal for both theatre and individual table settings.

Between the two suites we have our Boardroom - a smaller room which being totally separate is ideal for formal reviews and meetings.

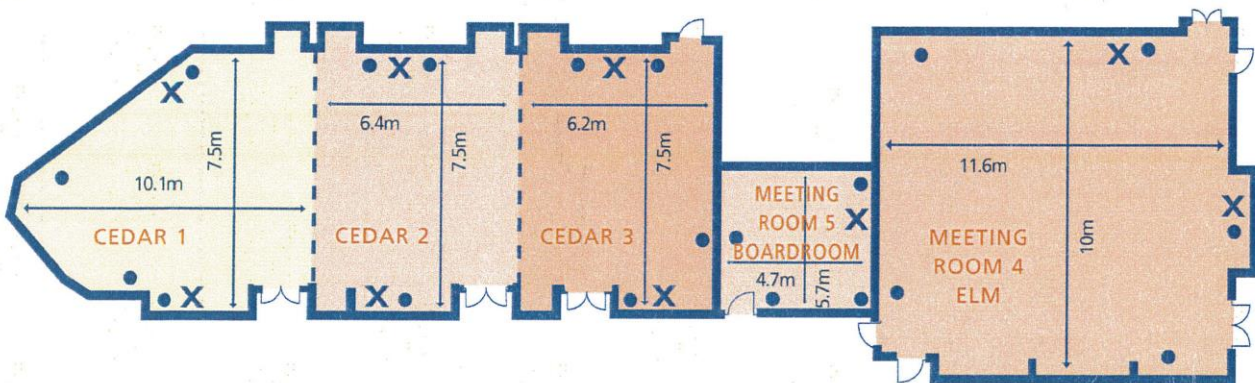

### KEY

- Power Point
- TV Socket
- C Dimmer Switch
- X Telephone Socket

### NORMANDY HOTEL – GLASGOW AIRPORT

Inchinnan Road, Renfrew, near Glasgow Airport, PA4 9EJ

tel: 0870 246 1780 fax: 0870 246 1781 email: normandysales@cosmopolitan-hotels.com

# FLOORPLAN

## THE BIRCH SUITE AND BREAKOUT ROOM

Our Birch Suite is located on the ground floor. It can hold up to 120 guests.  
The Birch Suite also leads onto our Breakout Room.

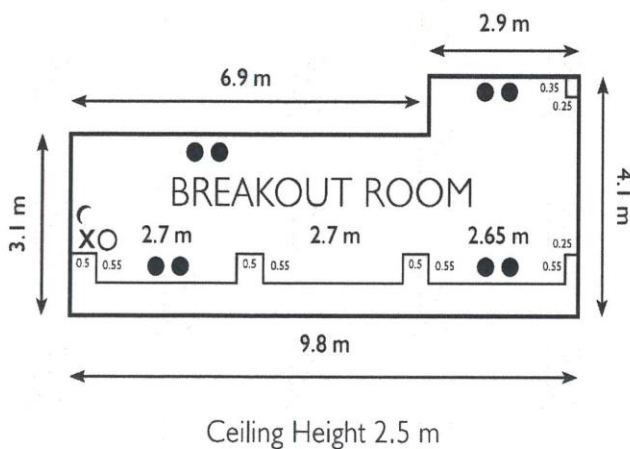
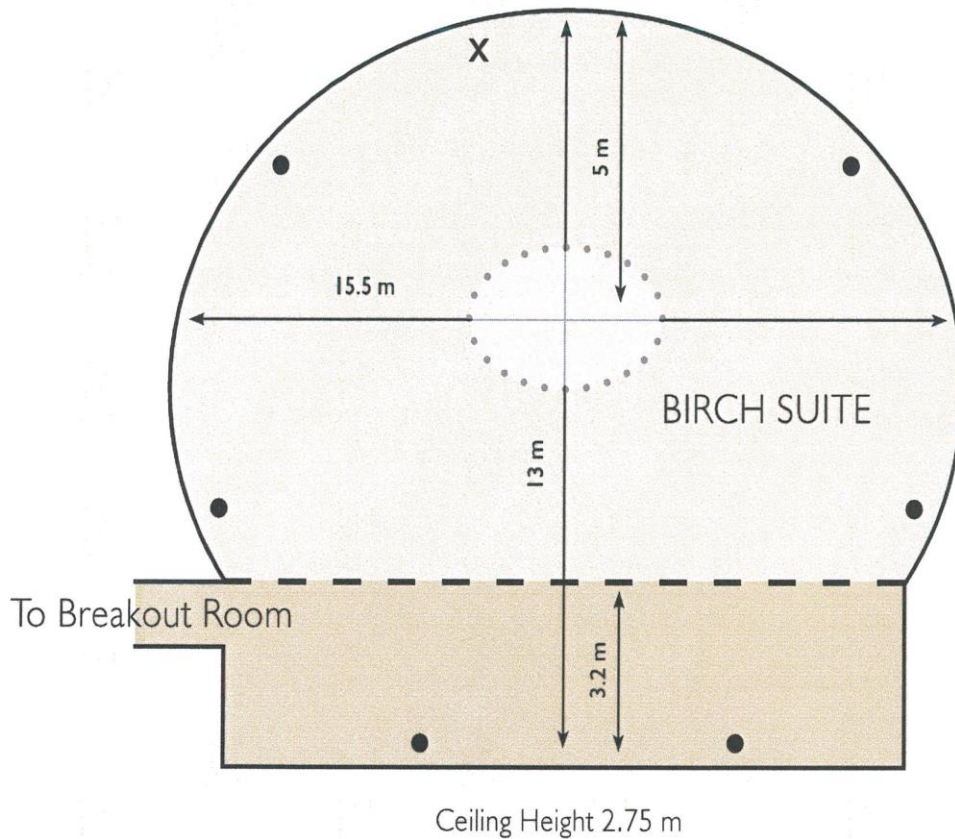

### KEY

- Power Point
- TV Socket
- ⊂ Dimmer Switch
- X Telephone Socket



## DELEGATE PACKAGES

### DAY DELEGATE PACKAGE

*Package includes:*

Room Hire Rate for up to 10 hours  
Delegate Paper & Pens  
LCD Projector & Screen  
Flipchart Paper & Pens  
Complimentary Wi-Fi  
Complimentary Car Parking

*Catering:*

1 Bottle of Water per person  
Tea, Coffee & Breakfast Rolls on arrival  
Mid-morning Tea, Coffee & Cookies  
Choice of either 2 Course Lunch or Finger Buffet  
Afternoon Tea, Coffee & Mini Scones

### 24 HOURS DELEGATE RATE

*Package includes:*

1 night's accommodation  
Room Hire Rate for up to 10 hours  
Delegate Paper & Pens  
LCD Projector & Screen  
Flipchart Paper & Pens  
Complimentary Wi-Fi  
Complimentary Car Parking

*Catering:*

Full Cooked Breakfast  
1 Bottle of Water per person  
Mid-morning Tea, Coffee & Cookies  
Finger Buffet Lunch  
Afternoon Tea, Coffee & Mini Scones  
3 Course Evening Meal